



ANATECH ELECTRONICS INC
RF & Microwave Filters & Products

1850-1915/1930-1995 MHz Cavity Duplexer

Part Number: AD1882-1962D439



Characteristics	Band 1 (Rx)	Band 2 (Tx)
Frequency:	1850-1915 MHz	1930-1995 MHz
Insertion loss:	=/<1.5 dB	=/<1.5 dB
Isolation:	50 dB min	50 dB min
Return loss:	18 dB min	18 dB min
Input power:	100 Watts	100 Watts
Impedance:	50 Ohms	50 Ohms

Mechanical	
Mounting Method:	Threaded Mounting Holes
Connector Type:	N-Type (F)
Dimensions:	6.18" x 6.06" x 1.54" in

Environmental	
Operating Temperature:	-40 to +70 deg.C
Storage Temperature:	-50 to +90 deg.C

Outline Drawing:

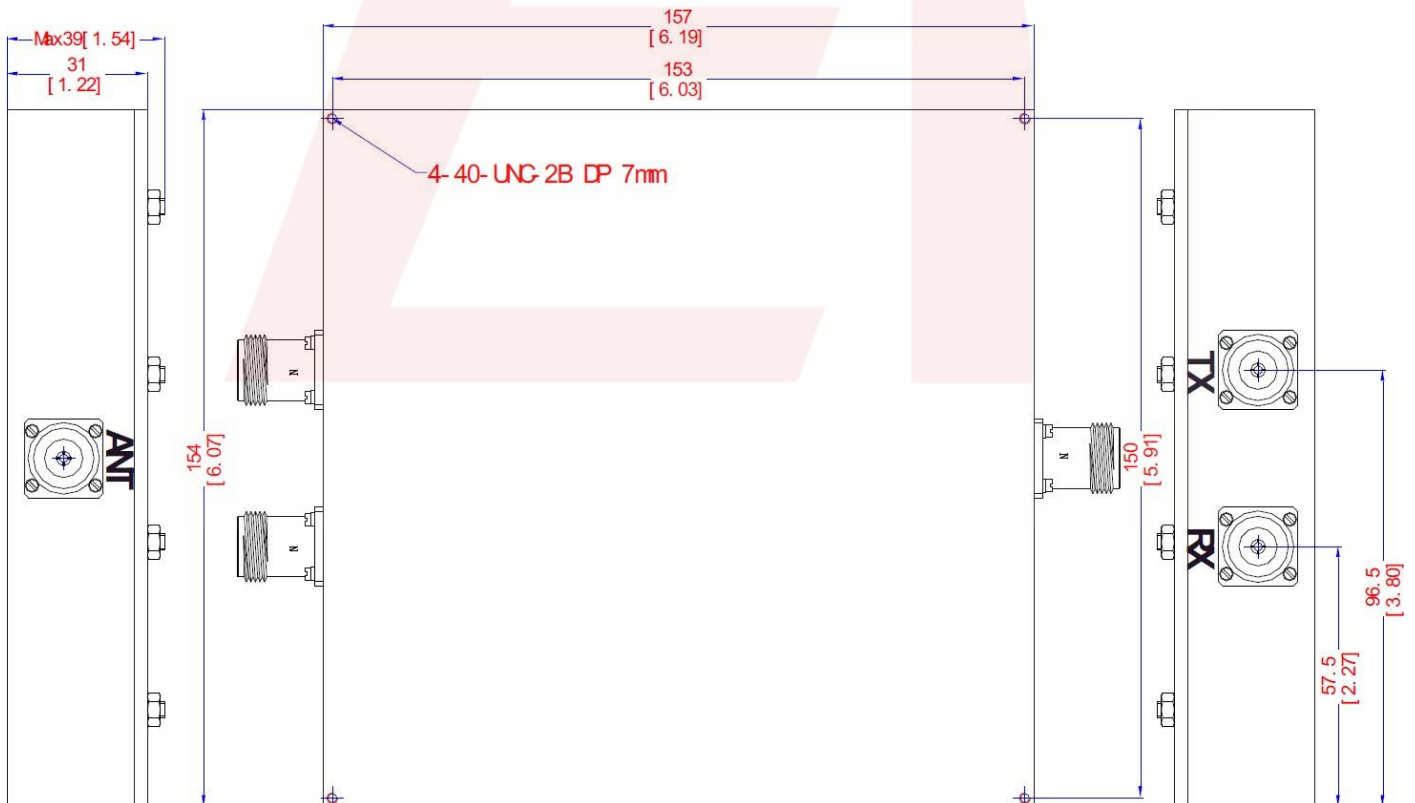



ANATECH ELECTRONICS INC
RF & Microwave Filters & Products

1850-1915/1930-1995 MHz Cavity Duplexer

Part Number: AD1882-1962D439



Response Plot:

