



ANATECH ELECTRONICS INC
RF & Microwave Filters & Products

3500 Hz LC High Pass Filter

Part Number: AE3500H9771



Electrical specifications

Cutoff Frequency (Fc): 3500 MHz

Passband: 3500-9000 MHz

Passband Insertion Loss: 2.0 dB Max.

Passband Return Loss: 10 dB Min.

Rejection: 40 dB Min. @ 0-1800 MHz

Mechanical

Mounting Method: through Holes

Connector Type: SMA (F)

Dimensions: 1.5 x 0.75 x 0.5 in

Environmental

Operating Temperature: -25°C to +70°C

Storage Temperature: -40°C to +90°C

Shock: 10 G. 11ms

Vibration: 10 G. 5 to 2000Hz

Outline Drawing:

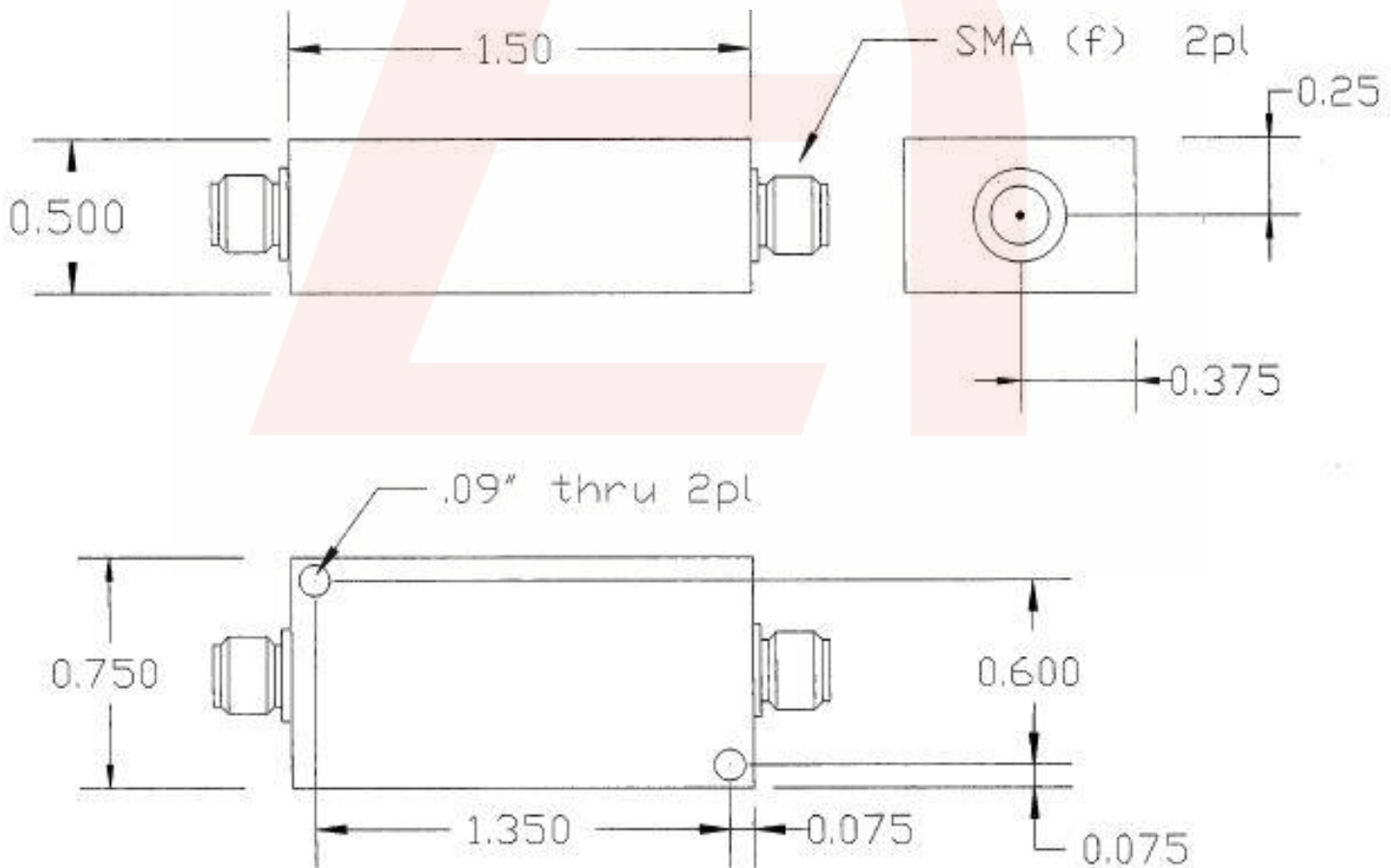



ANATECH ELECTRONICS INC
RF & Microwave Filters & Products

3500 Hz LC High Pass Filter

Part Number: AE3500H9771



Response Plot:

