



ANATECH ELECTRONICS INC
RF & Microwave Filters & Products

400 MHz LC Bandpass Filter

Part Number: **AE400B6374**



Electrical Specifications

Center Frequency: 400 MHz
Bandwidth: 20 MHz
Passband Frequencies: 390 MHz to 410 MHz
Impedance: 50 Ohms
Rejection: 60dB @ 0- 310 MHz
Rejection: >50dB @355 MHz
Insertion loss: 3dB
VSWR: 1.5:1

Mechanical

Mounting Method : Surface Mount
Connector Type: RF Pins 0.020 input pins
Dimensions: 1.5" X 0.5" x 0.4" in.

Environmental

Operating Temperature: -25°C to +70°C
Storage Temperature: -40°C to +90°C
Shock: 10 G. 11ms
Vibration: 10 G. 5 to 200Hz

Outline Drawing:

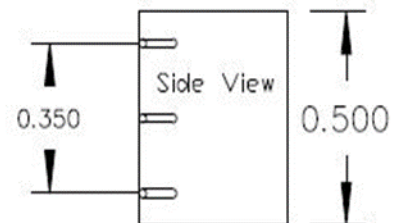
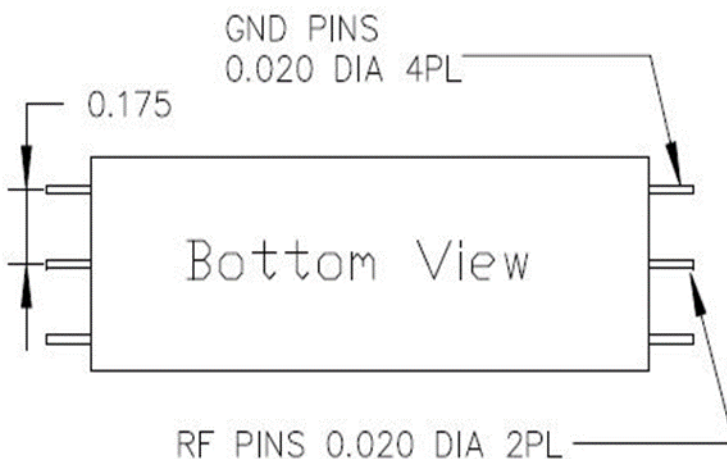
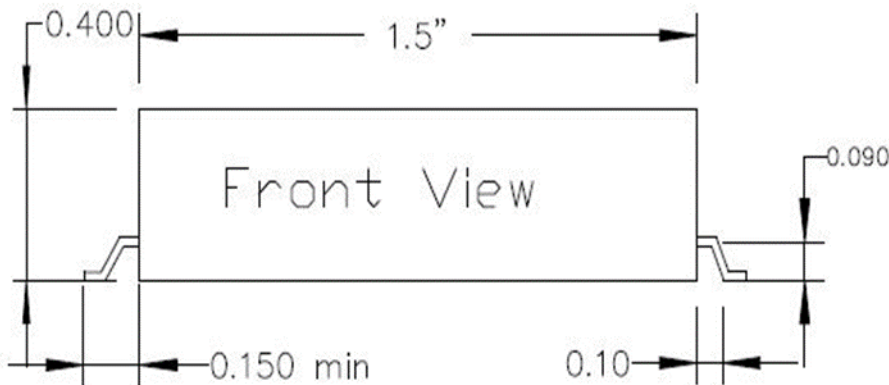



Response Plot:

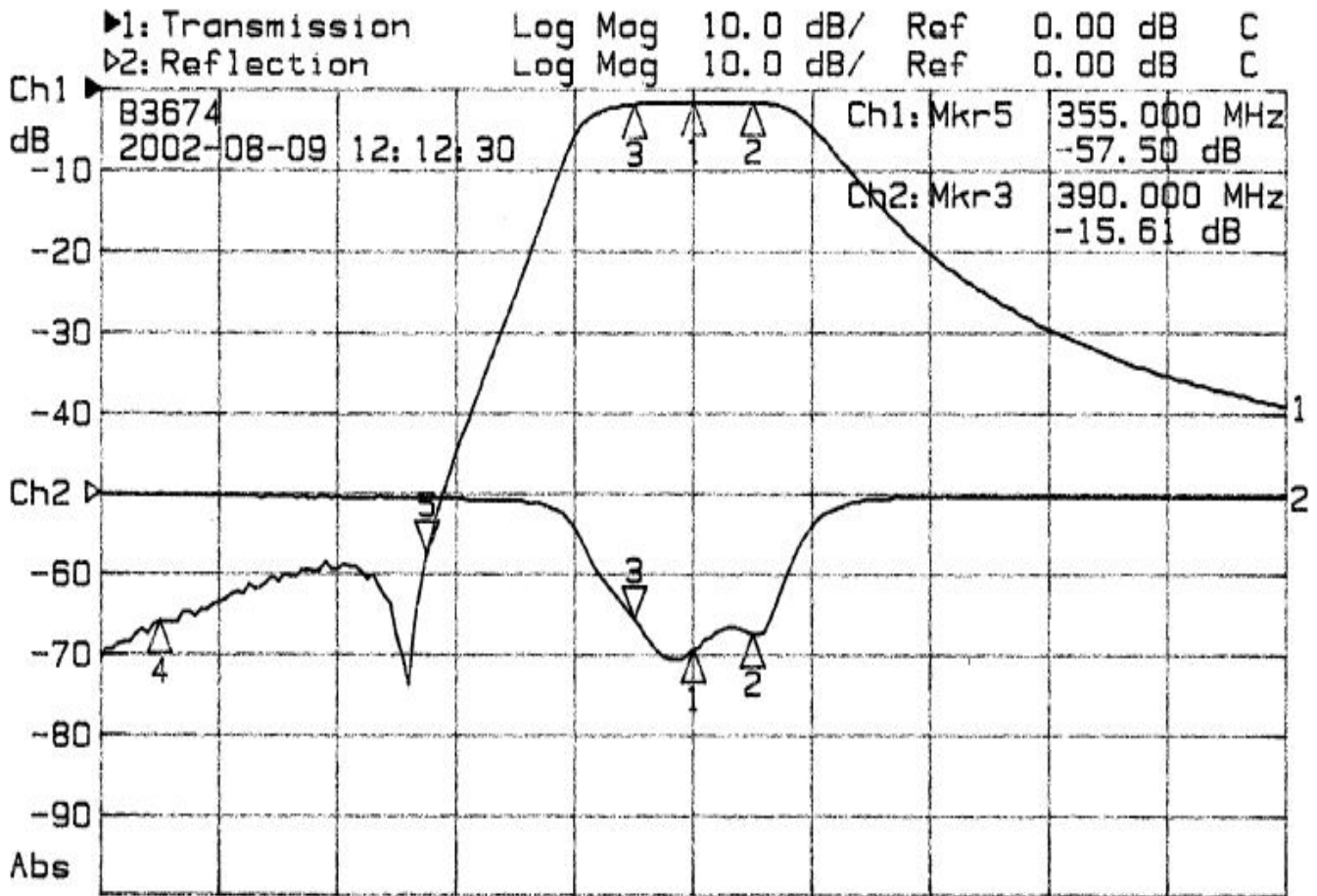

Start 300.000 MHz

Stop 500.000 MHz

1: Mkr (MHz)	dB	2: Mkr (MHz)	dB
1: 400.00	-1.47	1: 400.00	-19.51
2: 410.00	-1.54	2: 410.00	-17.38
3: 390.00	-1.79	3> 390.00	-15.61
4: 310.00	-65.93		
5> 355.00	-57.50		