

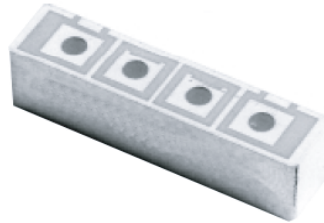

Electrical specifications

Center Frequency: 1090 MHz
Bandwidth: 6 MHz
Input / Output Impedance: 50 Ohms
Passband: 1087-1093 MHz
Passband Insertion Loss: 1087-1093 MHz 2.0 dB
Passband Ripple: 1.0 dB max
Passband Return Loss: 1087-1093 MHz 12.0 dB
Rejection: 970 MHz 55.0 dB min
Rejection 2: 1060 MHz 20.0 dB min
Rejection 3: 1120 MHz 20.0 dB min
Rejection 4: 1210 MHz 55.0 dB min
Power Handling: 1W



Mechanical

Mounting Method: SMT
Dimensions: 33.58 x 10.109 x 7.85 mm

Environmental

Operating Temperature: -30°C to +70°C
Storage Temperature: -50°C to +90°C

This product is RoHs compliant.

Mechanical Drawing

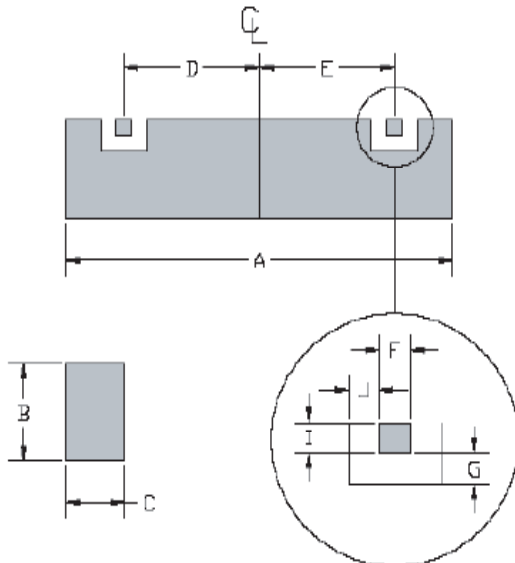

Dim	Nominal (mm)	Tolerance (mm) +/- or max
A	33.580	max
B	10.109	max
C	7.850	max
D	10.808	0.127
E	10.808	0.127
F	2.616	0.127
G	0.762	0.127
I	2.032	0.127
J	0.762	0.127



Response Plot:

