



Electrical specifications

Center Frequency: 1227 MHz
Bandwidth: 20 MHz
Input / Output Impedance: 50 Ohms
Passband: 1217.6-1237.6 MHz
Passband Insertion Loss: 1217.6-1237.6 MHz 1.0 dB
Passband Ripple: 1.0 dB max
Passband Return Loss: 1212.6-1242.6 MHz 12.0 dB
Rejection: 1152.6 MHz 29.0 dB min
Rejection 2: 1302.6 MHz 29.0 dB min
Power Handling: 1 W



Mechanical

Mounting Method: SMT
Dimensions: 38.6 x 11.8 x 7.2 mm

Environmental

Operating Temperature: -30°C to +70°C
Storage Temperature: -50°C to +90°C

This product is RoHs compliant.

Mechanical Drawing

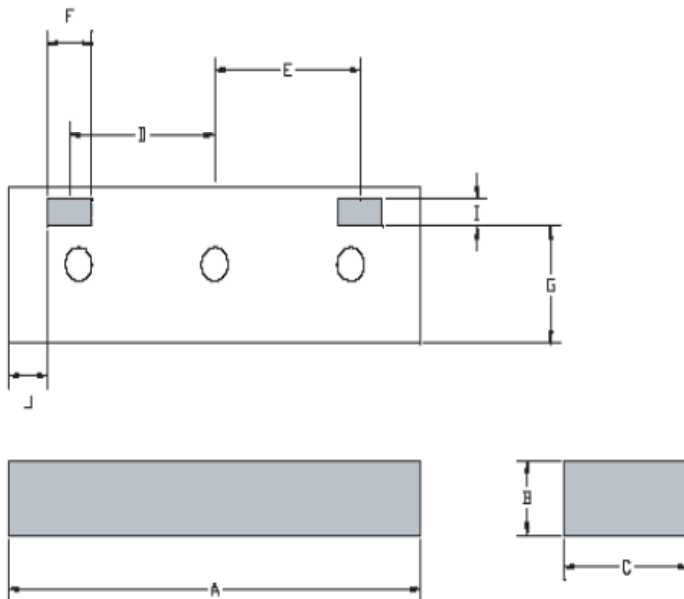

Dim	Nominal (mm)	Tolerance (mm) +/- or max
A	38.6	max
B	7.2	max
C	11.8	max
D	13.297	0.127
E	13.297	0.127
F	5.537	0.127
G	8.242	0.254
I	2.311	0.127
J	3.023	0.254



ANATECH ELECTRONICS INC
RF & Microwave Filters & Products

GPS Ceramic BPF

Part Number: AM1227B306



Response Plot:

