



Electrical specifications

Center Frequency: 1880 MHz
Bandwidth: 60 MHz
Input / Output Impedance: 50 Ohms
Passband: 1850-1910 MHz
Passband Insertion Loss: 1850-1910 MHz 1.9 dB
Passband Ripple: 1.0 dB max
Passband Return Loss: 1850-1910 MHz 10.0 dB
Rejection: 1574 MHz 33.0 dB
Rejection 2: 1740 MHz 26.0 dB
Rejection 3: 2018 MHz 14dB
Rejection 4: 2352 MHz 21.0 dB
Power Handling: 1 W

Mechanical

Mounting Method: SMT
Dimensions: 7.9 x 6.604 x 2.718 mm

Environmental

Operating Temperature: -30°C to +70°C
Storage Temperature: -50°C to +90°C

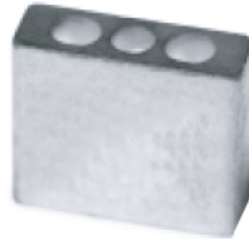

This product is RoHs compliant.

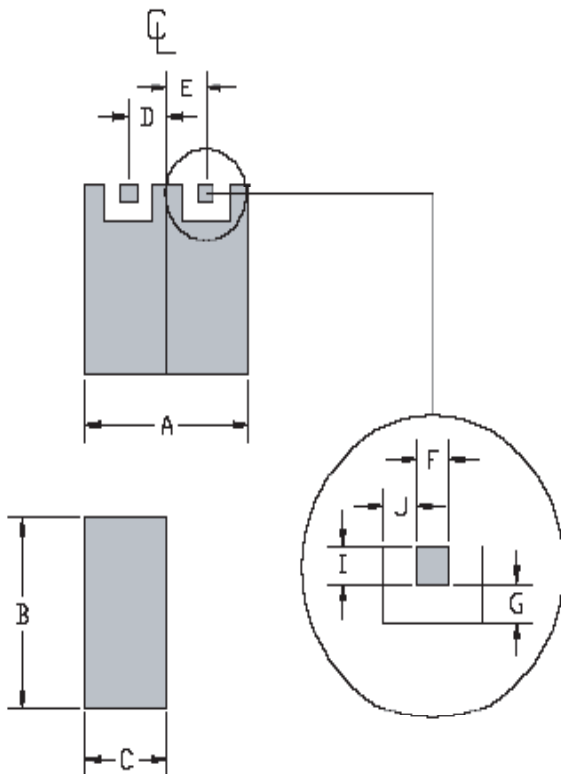

Dim	Nominal (mm)	Tolerance (mm) +/- or max
A	7.90	max
B	6.604	max
C	2.718	max
D	1.905	0.127
E	1.905	0.127
F	0.899	0.127
G	0.762	0.127
H		
I	1.27	0.127
J	0.762	0.127



ANATECH ELECTRONICS INC
RF & Microwave Filters & Products

PCS BANDPASS

Part Number: AM1880B335



Response Plot:

