



**Electrical specifications**

**Center Frequency:** 1960 MHz  
**Bandwidth:** 60 MHz  
**Input / Output Impedance:** 50 Ohms  
**Passband:** 1930-1990 MHz  
**Passband Insertion Loss:** 1930-1990 MHz 3.8 dB  
**Passband Ripple:** 1.0 dB max  
**Passband Return Loss:** 1930-1990 MHz 10 dB  
**Passband Variation:** 1930-1990 MHz 3.2 dB  
**Rejection:** 1850-1910 MHz 37 dB  
**Rejection 2:** 3700-3900 MHz 10 dB  
**Power Handling:** 1 W

**Mechanical**

**Mounting Method:** SMT  
**Dimensions:** 7.05 x 6.25 x 2.05 mm

**Environmental**

**Operating Temperature:** -30°C to +70°C  
**Storage Temperature:** -50°C to +90°C

**This product is RoHs compliant.**



Mechanical Drawing

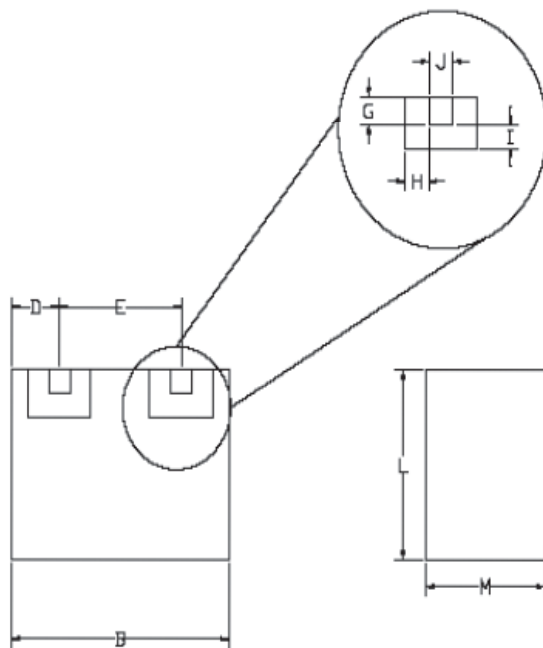

Dim	Nominal (mm)	Tolerance (mm) +/- or max
A		
B	7.05	max
C		
D	1.55	0.25
E	3.86	0.13
F		
G	0.66	0.13
H	0.66	0.13
I	0.66	0.13
J	0.66	0.13
K		
L	6.25	max
M	2.05	max



**ANATECH ELECTRONICS INC**  
RF & Microwave Filters & Products

# PCS Bandpass

## Part Number: AM1960B545



### Response Plot:

