



**Electrical specifications**

**Center Frequency:** 2350 MHz  
**Bandwidth:** 100 MHz  
**Input / Output Impedance:** 50 Ohms  
**Passband:** 2300-2400 MHz  
**Passband Insertion Loss:**  
**Passband Ripple:** 2300-2400 MHz 1.00 dB  
**Passband Return Loss:** 2300-2400 MHz -10.00 dB  
**Rejection:** 0.1 – 2100 MHz -40.00 dB  
**Rejection 2:** 2600 – 5000 MHz -40.00 dB  
**Power Handling:** 2 Watt max

**Mechanical**

**Mounting Method:** SMT  
**Dimensions:** 10.20 x 7.90 x 4 mm

**Environmental**

**Operating Temperature:** -30°C to +70°C  
**Storage Temperature:** -50°C to +90°C



**Mechanical Drawing**

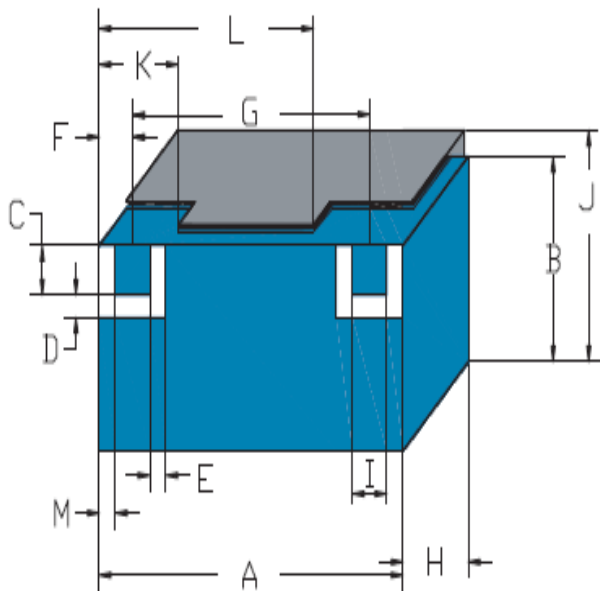

Dim	Nominal (mm)	Tolerance (mm) +/- or max
A	10.20	Max
B	6.90	Max
C	1.60	0.13
D	0.80	0.13
E	0.80	0.13
F	1.20	0.13
G	7.80	0.13
H	4.00	Max
I	1.40	0.13
J	7.90	Max
K	2.70	0.13
L	7.50	0.13
M	0.50	0.13



### Response Plot:

